

# Pressure Gauges and Gauge Blocks

## G Series

Maximum Working Pressure:  
**700 & 1000 bar**

Dial Diameter:  
**63 & 100mm (2-1/2" & 4")**

Accuracy:  
**±1% & 1.6% of full scale**

Scale:  
**bar & bar/kN**



### FEATURES

#### Pressure Gauges

- Pressure Gauges available in Ø63 or Ø100mm dial with read-out in bar and psi scales.
- The 1000 bar pressure gauges are glycerine-filled while the 700 bar pressure gauges are dry.
- The G106L pressure gauge has a 1/4" NPT screwed connection at 3 o'clock for direct installation on the left side of certain pump head.
- The G10 pressure gauges are also available in dual scale version (bar and kN) to suit different types & in respective of the tonnage capacities of cylinders. *Refer selection chart.*

#### Gauge Blocks

- Manufactured in steel and available in 4 versions to suit gauge diameter and distance from the tool.

### SELECTION CHART FOR FORCE & PRESSURE GAUGES (DRY)

MODEL (G10 Series)	Scale bar	Scale kN	For Cylinders	Dimensions
<b>G10F1020</b>	700	0-121 / 0-225	CMF 10/20 ton	See G10 chart
<b>G10F3060</b>		0-327 / 0-578	CMF/COF 30/60 ton	
<b>G10S1020</b>		0-109 / 0-194	CGS/CMC/CM/CM/COI 10 ton CGS/CMC/CMP 20 ton	
<b>G10S2530</b>		0-228 / 0-303	CMI 25 ton - CGG/CGS/CMC/CM/CM/COI 30 ton	
<b>G10S50100</b>		0-486 / 0-911	CGG/CGS/CMC/CM/CM/CM/CM/COI/COS 50/100 ton	

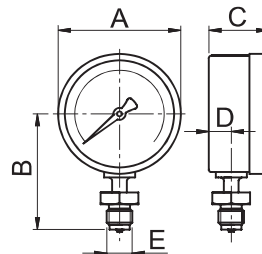

### PRESSURE GAUGE SELECTION CHART: 700 - 1000 BAR (GLYCERINE-FILLED)

Max Working Pressure	* Full Scale	Dial Diameter	Precision Class DIN16005	Scale Indexing	Thread	Mounting	MODEL	Dimensions (mm)				Weight kg
								A	B	C	D	
700	1000	63	1,6	50	1/4" NPT	Radial Fit	<b>G106L</b>	68	54	32	13	0,2
						Lower Fit	<b>G106</b>					
1000	1000	100	1,0	20	1/2" BSP Swivel	Lower Fit	<b>G10</b>	101	98	49	15,5	0,8

\* Dual Scale: bar & psi

### SELECTION CHART FOR 1000 BAR GAUGE BLOCKS TO BE MOUNTED IN-LINE

MODEL	Max Working Pressure	Gauge Connection	In/Out Connection	A Dimension	Weight
	bar			mm	kg
<b>RP52</b>	1000	1/4" NPT	3/8" NPT	100	0,40
<b>RP50</b>				60	0,28
<b>RP501</b>		1/2" BSP		90	0,33
<b>RP502</b>				140	0,42

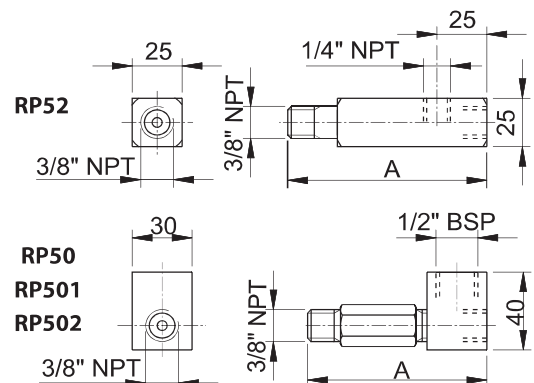

Pressure range of gauges 1600, 3000 & 4000 bar available upon request.  
Adapters range for gauges 1000, 1600 & 3000 bar available upon request.