

2 & 3 Grip Jaw Hydraulic Puller Sets

UEG Series – Standard Jaw Puller

UEZ Series – Self-Aligning Jaw Puller

Capacity:

10 – 20 – 30 – 50 tonnes

Maximum Reach:

268 – 731 mm

Maximum Spread:

250 – 920 mm

Maximum Operating Pressure:

(Refer Data Charts)

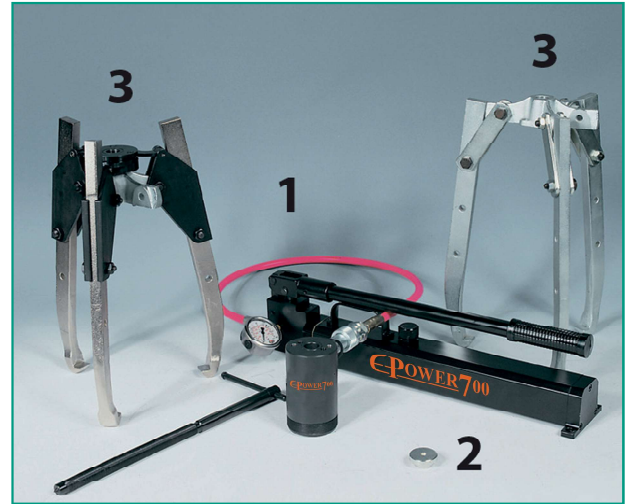
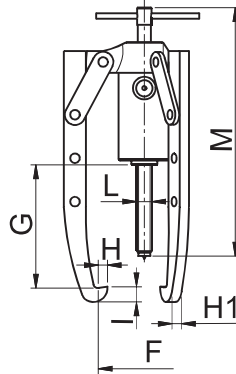

SELECTION CHART FOR STANDARD (UEG) AND SELF ALIGNING TYPE (UEZ) JAW PULLERS

Description		Cap - Tonnes:	MODEL			
			10	20	30	50
		Standard:	UEG10	UEG20	UEG30	UEG50
		Self-Aligning:	UEZ10	UEZ20	UEZ30	UEZ50
HYDRAULICS UEU#		* Pos.				
Hand Pump		1	PN131	PN141	PN141	PN162
Cylinder			CMF10N50E	CMF20N50E	CMF30N50E	CMF60N75E
Hose			SN20M	SN20M	SN20M	SN20M
Pressure Gauge			G106L	G106L	G106L	G106L
Max. Operating Pressure		-	560 bar - 3 Jaw (375 bar - 2 Jaw)	600 bar - 3 Jaw (400 bar - 2 Jaw)	615 bar - 3 Jaw (405 bar - 2 Jaw)	580 bar - 3 Jaw (390 bar - 2 Jaw)
MECHANICAL PARTS	UEG#M UEZ#M	* Pos.				
Protection Saddle		2	UETS10	UETS20	UETS30	UETS50
Number of Jaws		3	*2/3	2 & 3	2 & 3	2 & 3
Minimum Spread (mm)		F	50	70	90	120
Maximum Spread (mm)			250	480	580	920
Maximum Reach (mm)		G	268	335	425	731
Jaw Width (mm)		H	14	18	25	30
Jaw Depth (mm)		H1	15	20	22	25
Jaw Thickness (mm)		I	25	32	42	50
Adjusting Screw Thread		L	3/4" - 16 UNF	1" - 8 UNC	1 1/4" - 7 UNC	1 5/8" - 5,5 UNC
Adjusting Screw Length		M	400	670	790	975
Weight 2/3 Jaw		kg	12	22/27	36/45	85/103

* Pos.: Position as shown on illustrated picture & jaw puller drawings.

* Universal crosshead for UEG Puller



The jaw puller **UEZ** is fitted with a self aligning mechanical device to synchronise closing of the jaws on the workpiece so that precise positioning can be obtained.



Each puller component has a different **operating pressure** which must never be exceeded. Please refer to data charts.

